

past projects



Proud To Lend A Helping Hand

The Walsh Family Village is part of a lodging project located on the Avera McKennan medical campus in Sioux Falls, South Dakota. The mission of the project is to provide housing and assistance for families and patients that travel from outlying areas to receive treatment at Avera McKennan Hospital, and who are not able to afford traditional housing options. The three-building village was funded entirely by donations, and includes facilities for adult and pediatric patients and their families, guests with special needs, and community space for play, meditation and other activities.

Each of the buildings was built with its own distinct purpose, and came with a variety of requirements for electrical service, and equipment. Thompson Electric Company is proud to have been a part of the construction team on this charitable project, designing and installing interior and exterior systems for power, lighting, data, telephone and fire alarms.

The last of the three buildings to be constructed, the Ronald McDonald House, provided us with an opportunity to give back to our community. As a gift to this outstanding facility, and the organizations involved, Thompson Electric Company and our employees donated materials and labor toward the completion of the building.



Walsh Family Village

Avera 

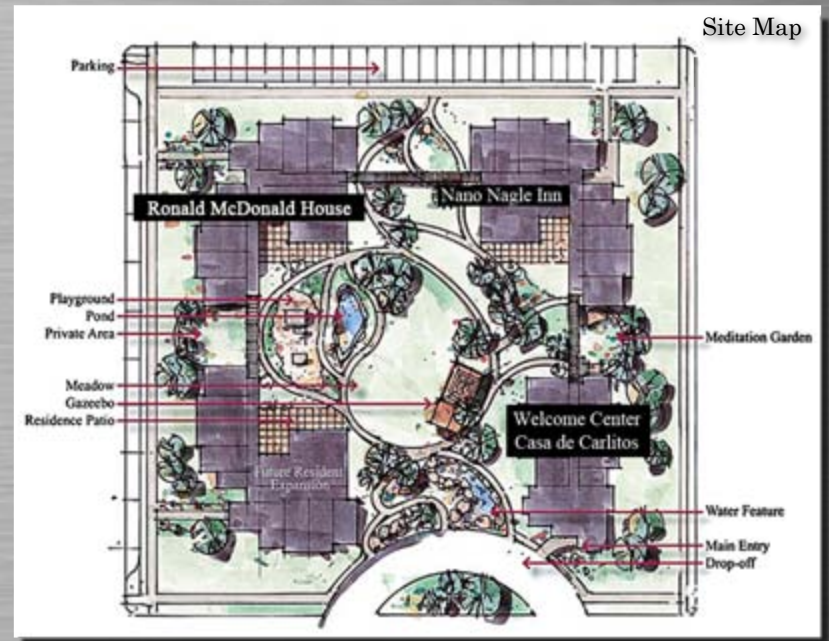

Key Collaborators:

- Sioux Falls Construction
- BWBR Architects